

DSM series Aluminum Alloy Dovetail Bearings Linear Stages



Naming Rules:

DSM 50 S-65 90 E

DSM: Aluminum alloy Dovetail Bearings

Travel:
13: 13mm
20: 20mm
25: 25mm
50: 50mm
100: 100mm

Table Width:
40: 40mm
60: 60mm
65: 65mm

Body Length:
40: 40mm
60: 60mm
65: 65mm
90: 90mm
140: 140mm

E: The base has the same size with the table top
L: The base is longer than the table top

Selection Table

Model	DSM13S-4040E	DSM20S-6060E	DSM25S-6565E	DSM50S-6590L	DSM100S-65140L
Travel(mm)	13	20	25	50	100
Table Size(mm)	40×40	60×60	65×65	65×65	65×65
Body Length(mm)	40	60	65	90	140
Thickness(mm)	20				
Bearings	Dovetail Bearings				
Drive Position	Center drive				
Weight(Kg)	0.12	0.22	0.25	0.3	0.4
Horizontal Load(Kg)	5	8	10	10	10
Vertical Load(Kg)	2	3.5	5	5	5

Dimensions:

DSM13S-4040E

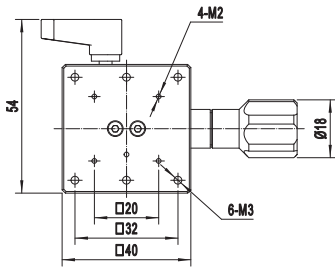
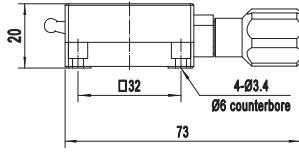
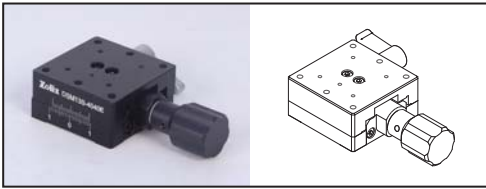

DSM20S-6060E

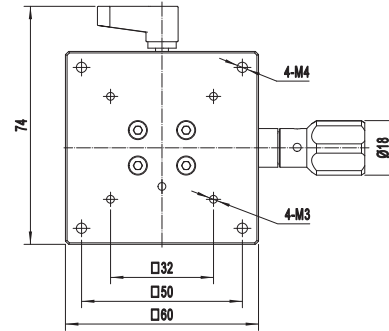
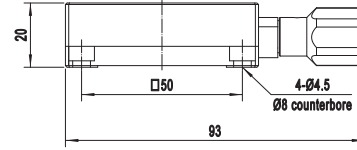
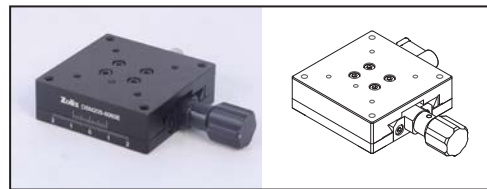

DSM25S-6565E

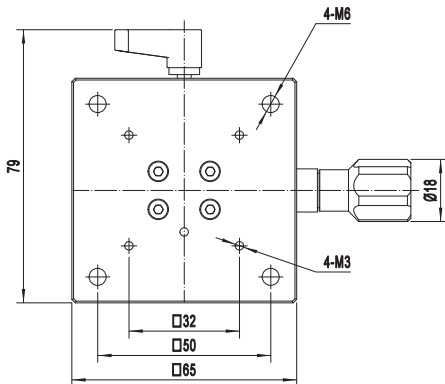
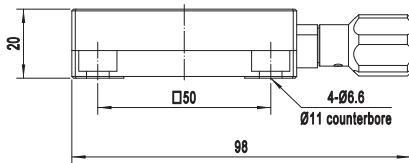
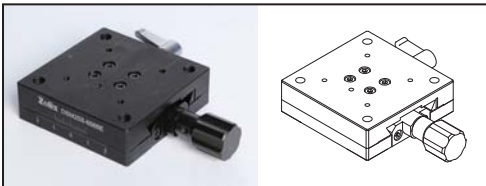

DSM50S-6590L

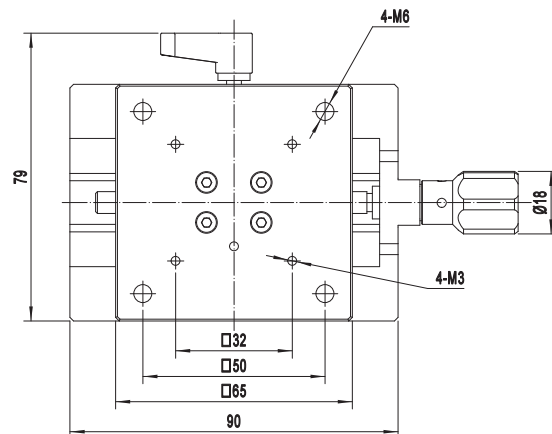
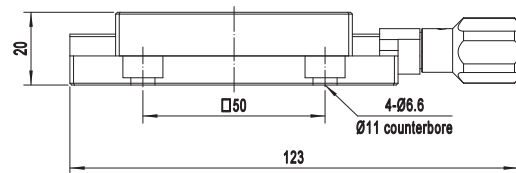
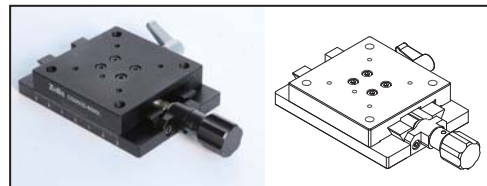

DSM100S-65140L

